



Body: **Steel**
Stem: **Steel**
Dome head





Hülse: **Stahl**
Dorn: **Stahl**
Flachrundkopf

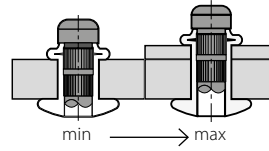
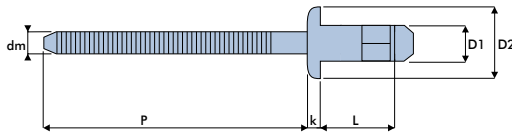

Cuerpo: **Acero**
Vástago: **Acero**
Remache alomada

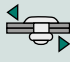

D1	L	 min - max		D2	k max.	dm ref.	p min.	 [N]	 [N]	code
mm	mm	mm	mm	mm	mm	mm	mm	[N]	[N]	
4.8	9.0	1.5 - 3.5	4.9 - 5.1	9.5	2.4	3.10	30	3800	4600	75SS14809
	11.5	3.5 - 6.0						3800	5700	75SS14811
	14.0	6.0 - 8.5						3800	6100	75SS14814
	16.5	8.5 - 11.0						3800	6100	75SS14816
6.4	9.0	1.5 - 3.5	6.5 - 6.7	12.8	2.9	4.17	32	7500	12500	75SS16409
	10.5	2.8 - 4.8						7500	12500	75SS16410
	11.5	3.35 - 5.35						7500	12500	75SS16411
	12.5	4.8 - 6.8						7500	12500	75SS16412
	14.5	6.8 - 8.8						7500	14000	75SS16414
	15.5	7.5 - 9.5						7500	15000	75SS16415
	16.5	8.8 - 10.8						7500	15000	75SS16416
	17.5	9.8 - 11.8						7500	15000	75SS16417
	18.5	10.8 - 12.8						7500	16000	75SS16418
	19.5	11.8 - 13.8						7500	16000	75SS16419
20.5	12.8 - 14.8						7500	16000	75SS16420	



Unit 7, Thame 40, Jane Morbey Road, Thame. OX9 3RR

Free Phone 0808 123 1221

Fax 0845 812 1221

Email sales@zygology.com

Website www.zygology.com